

I'm water-proof
Comply with IP64 Standard



9.7" RUGGED MOBILE DATA TERMINAL

- Rugged industrial design with IP64 rating
- Powerful Freescale iMX6 Quad core 1GHz solution
- 9.7" 1024x768 IPS screen capacitive touch
- Built-in 7.4V 5000mAh battery
- Rich extensions: RS232, RS485, RS422, Gpio, CAN bus, LAN
- Gravity sensor, OTG, TF & USB
- PoE(Power over Ethernet) GbE Ethernet
- 2G/3G/4G/Wi-Fi/Bluetooth/GPS/camera



RUGGED INDUSTRIAL DESIGN

It features customized ABS material accompanying 4-corner rubber mat and IP64 rating, which offer a 360° protection to prevent from shock, dust and water; All interfaces are equipped with protective components to cope with complex industrial environment.



QUAD CORE CPU



It uses a Freescale i.MX6 processor, an architecture based on ARM Cortex A9 1GHz speed with a high-performance Quad core CPU, it's stable and reliable. The processor makes the multimedia performance more powerful, to meet various field applications.

POWER OVER ETHERNET



Power over Ethernet (PoE) describes any of several standardized or ad-hoc systems which pass electrical power along with data on Ethernet cabling. This allows a single cable to provide both data connection and electrical power to devices such as wireless access points or IP cameras.

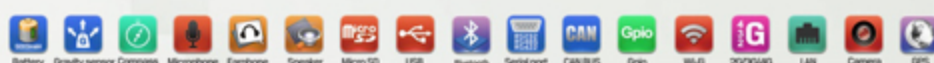

APPLICATION INDUSTRIES

Rich resource working with Android, Windows CE or Linux OS to apply in different fields, eg. Fleet management, large warehouse management, agriculture & construction vehicle, manufacturing, retail, portable medical device, Human-machine interface, intelligent industrial control system, electric power industry, catering and entertainment, port terminal, container freight, etc.

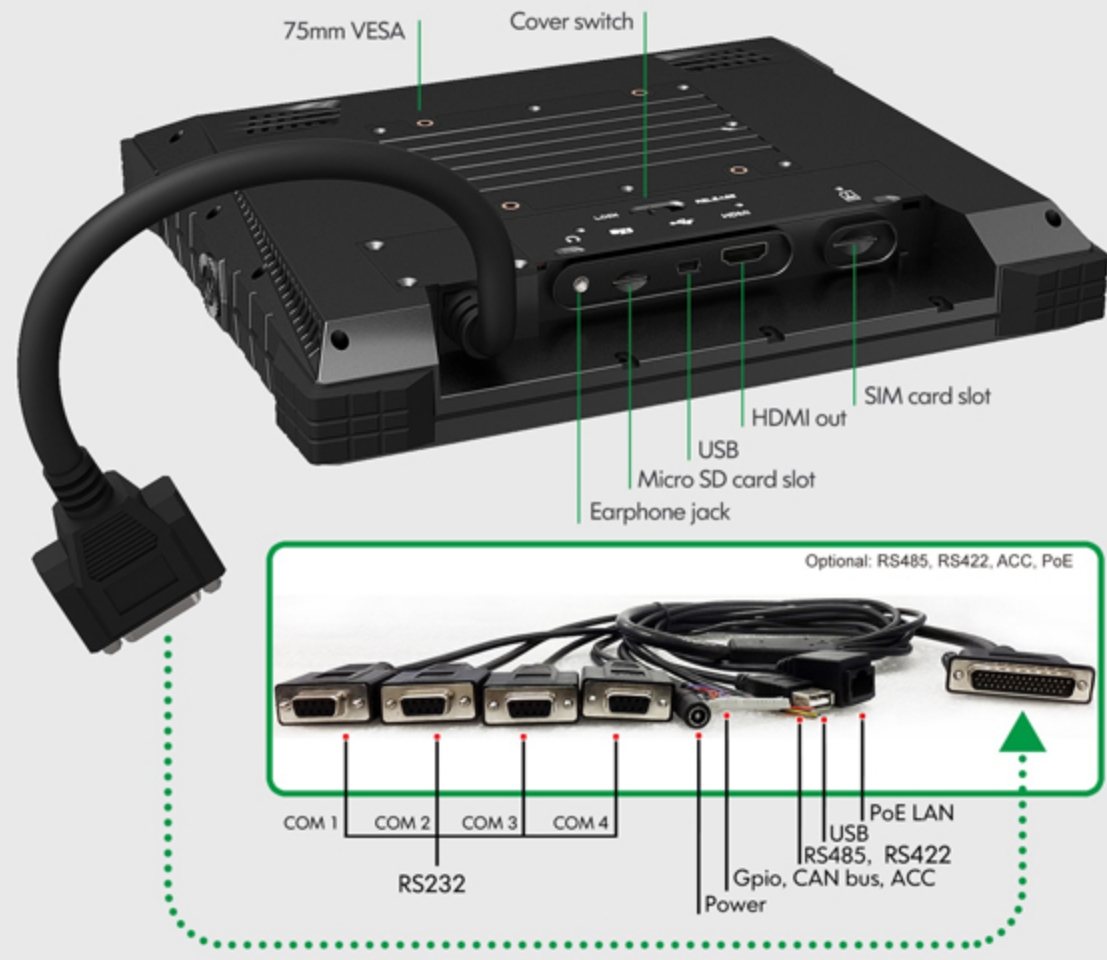
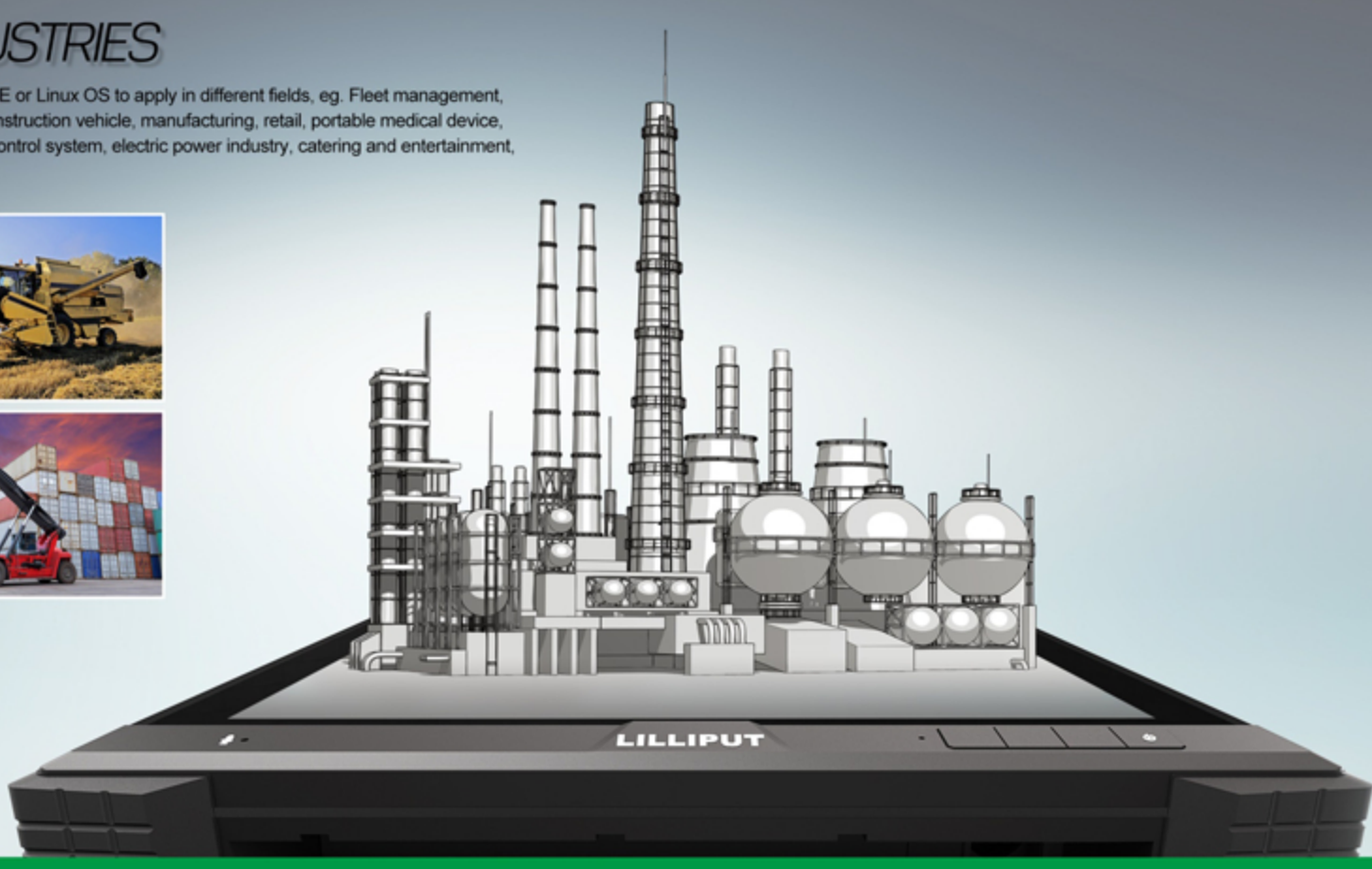

System configuration	CPU Freescale iMX6 Quad core 1.0GHz 4xARM Cortex-A9 up to 1.2 GHz per core ROM: 8GB Flash, RAM: DDR3-1066 (533MHz) 1GBytes, up to 2GBytes GPU 3D 200Mtri/s 1000Mpxl/s, OpenGL ES 3.0 & Halti, CL EP OS: Android 4.3.1 / Linux Debian 7.0 / WinCE 7.0 Audio: MP3, MP4, WMA, WAV...
Media	Video Decode 1080p60 H.264 Video Encode 1080p30 H.264 BP/ Dual 720p
Interface	HDMI output Micro SD card slot USB Device 2.0, USB host 2.0 Earphone jack DC power input RS232x4 / RS232x3, RS485x1 / RS232x2, RS422x1, RS485x1 (optional RS485/RS422 interface) LAN Ethernet Gpio inputx4, Gpio outputx6 Optional:3G/Wi-Fi & Bluetooth/Camera/GPS/ACC/PoE (Power over Ethernet)
Touch Panel	Capacitive
Display	9.7"
Screen Resolution	1024x768
Brightness	350cd/m ²
Contrast	900:1
Viewing Angle	178°/ 178° (H/V)
Power supply	DC 9-36V
Battery	Built-in 5000mAh
Power Consumption (Normal mode)	≤9W
Power Consumption (Charging mode)	≤24W
Working Temperature	-20°C~60°C
Storage Temperature	-30°C~70°C
Dimension (LWD)	252x211x37mm
Weight	1340g

ACCESSORIES

Extended cable	DC adapter	Mini USB cable
Touch pen	CD drive	5000mAh Battery (optional)
Gimbal bracket (optional)	VESA 75mm rail slot (optional)	75mm VESA folding bracket (optional)

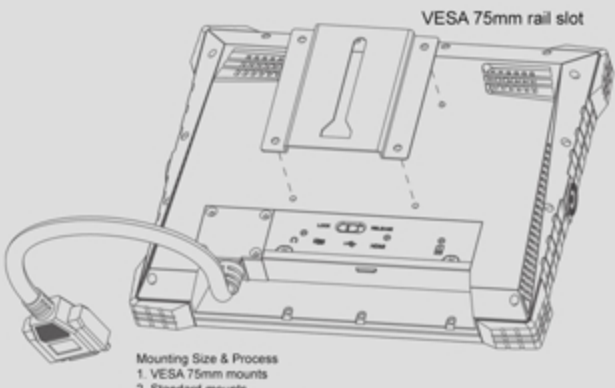

T3000 Building System

